

# \$49,000 - Lot 9 Deerfoot CRT

**Listing ID: M114879**

**\$49,000**

Vacant Land

Lot 9 Deerfoot CRT, Steeves Mountain,  
New Brunswick, E1G4P5

This is a new subdivision with a spectacular view and only a few minutes from the top of Mountain Road. 3 properties developed with large modern homes overlooking the valley leading to the Caledonia Mountain. 7 more about to be developed. Lot is well graded. If you were thinking about having a nice piece of property with a great view and not far from city centre, you should really come by...or take the attached video tour. Several schools within 15 minutes drive including: Harrison Trimble (9 - 12); L'Odyssée (9-12); Le Mascaret (6-8), Le Sommet (M-8), Magnetic Hill School (K-8) Please note: PIDs and PANs are not yet subdivided, but they will be in time for closing; therefore, there is no assessment of the subdivided lots at this time. **DRONE FOOTAGE AVAILABLE. SEE LINK.** (id:11392)

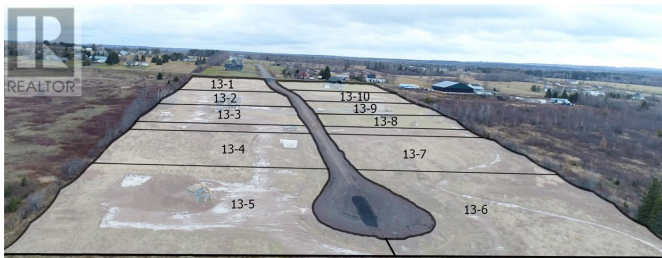

MLS®, REALTOR®, and the associated logos are trademarks of The Canadian Real Estate Association

Data Provided by: Greater Moncton REALTORS® du Grand Moncton

Last Modified: 06/06/2018 09:06:21 AM

Listing Office:Creativ Realty